

# Installation Notice

Be sure the surface where you install your pergola is completely flat.

If you have any doubt call a specialist

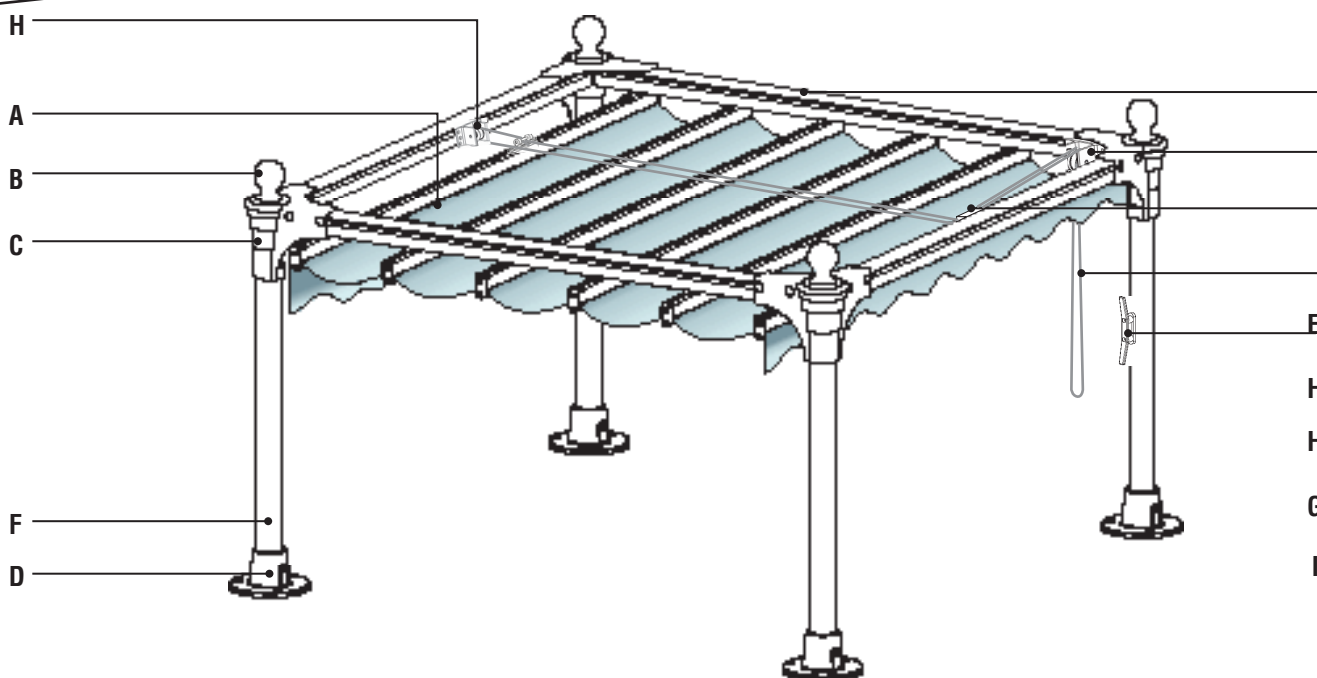

## Components

**A** 1 Complete trolley

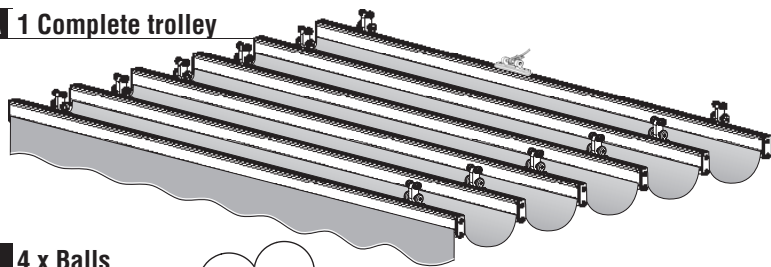

**B** 4 x Balls

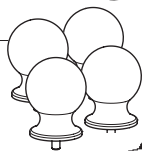

**C** 4 x corners

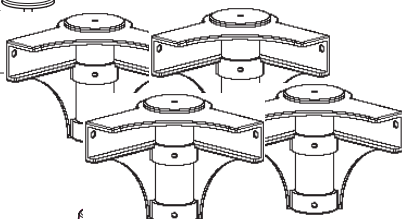

**D** 4 x bases

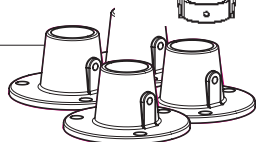

**E** 4 x profiles

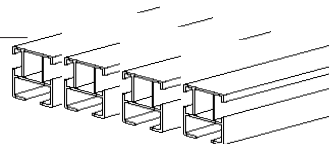

**F** 4 x tubes Ø50 mm



**G** 1 rope



**H** Different pulleys

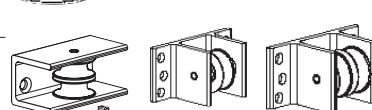

**I** Stop rope



**Visserie**

16 butterfly screws, 16 screws 6 pans, 6 metal screw N°10, 22 plates, 2 metal screw, 2 vis plaque d'arrêt.

# 1

## PREPARATION

A

1/ Darg the 2 fixing plates in the profile with adequate placement.

2/ Place the pulleys and screw blocking ....using the key on the 6 sides.

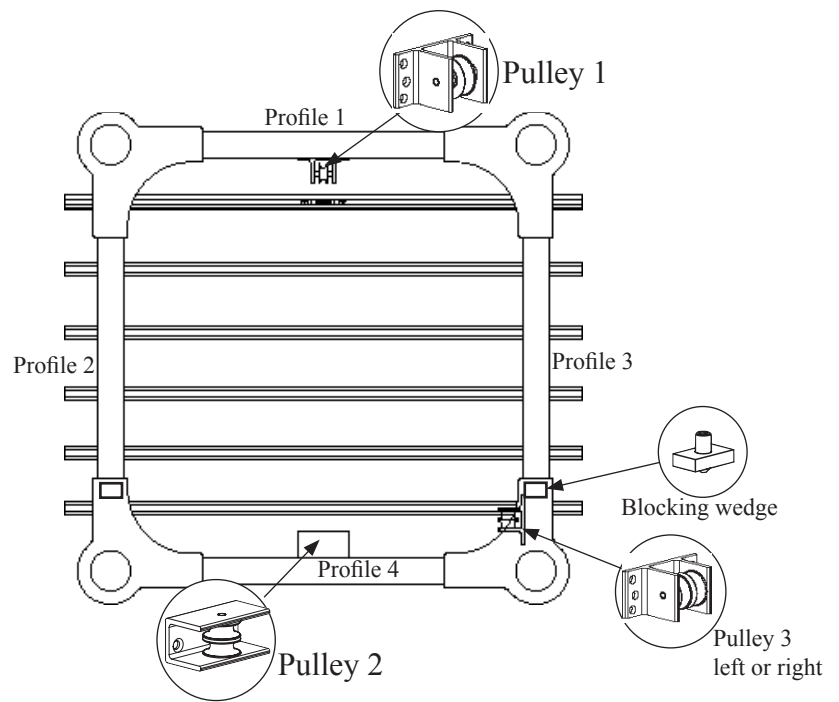

B

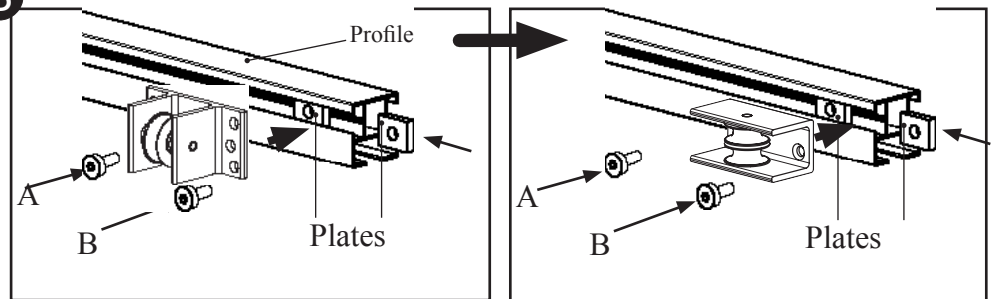

# 2

Before starting the installation attach the pulleys to the matching profile. (fig A). Otherwise your pergola won't work properly.

C

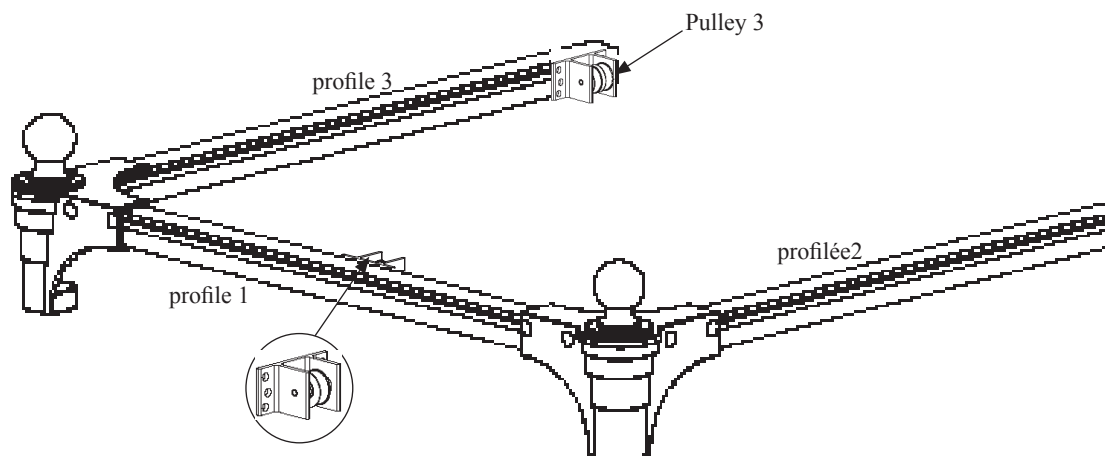
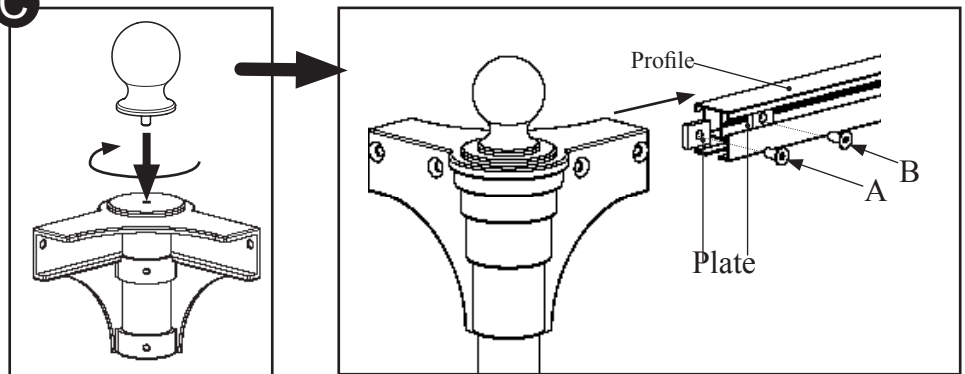

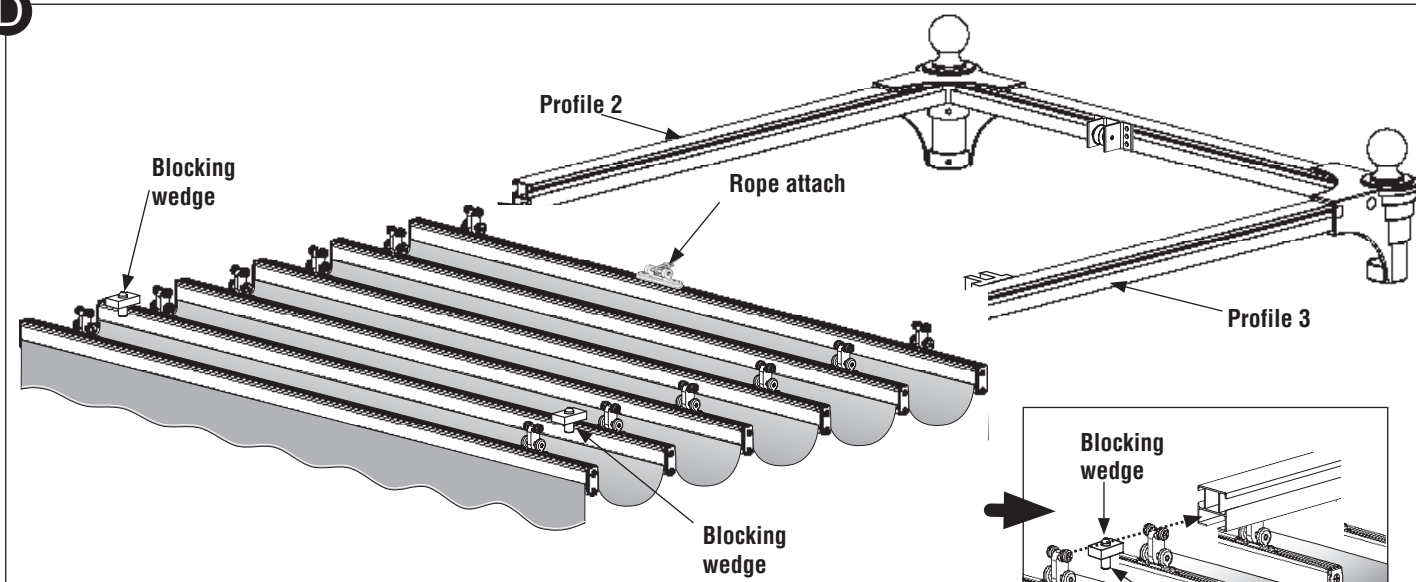
**D****3**

**IMPORTANT** slide de blocking wedge before the last trolley

Slide the trolleys one by one in the profiles 2 and 3.

**4**

1/Installe the 2 other corners on the profile 4.  
2/ Attach the whole pergola together

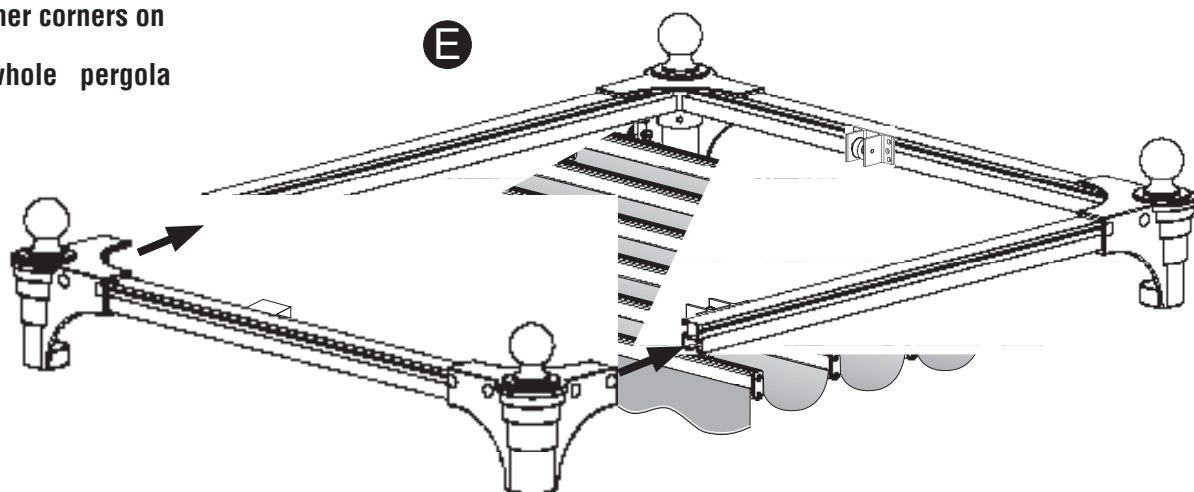
**5**

1/ Lift the whole pergola and slide the tubes in the corner and tight the butterfly.  
2/ Slide the tube.

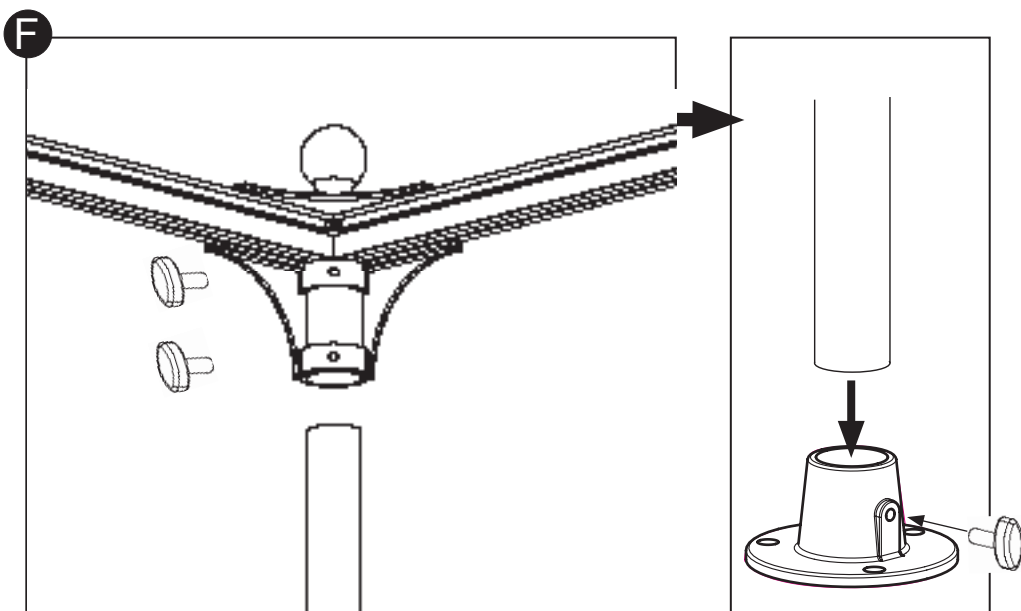

## 6

## Rope

**1/ Place the rope pulleys following the patch**

**2/ Attach the two extrimitees with rope and towers and pinch the claming rings.**

### 3/ Test and pull from one direction to another

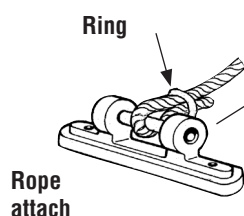

## 7

## Stoppage rope

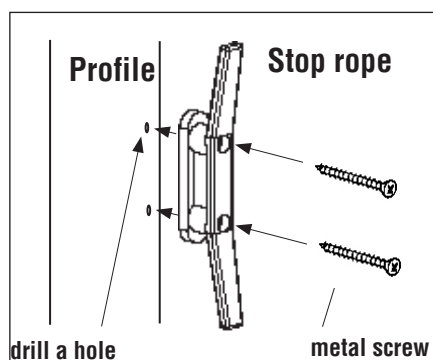

## 8

### Attachment to the floor

**Place screws on ground and adjust according to the type of soil for stability.**

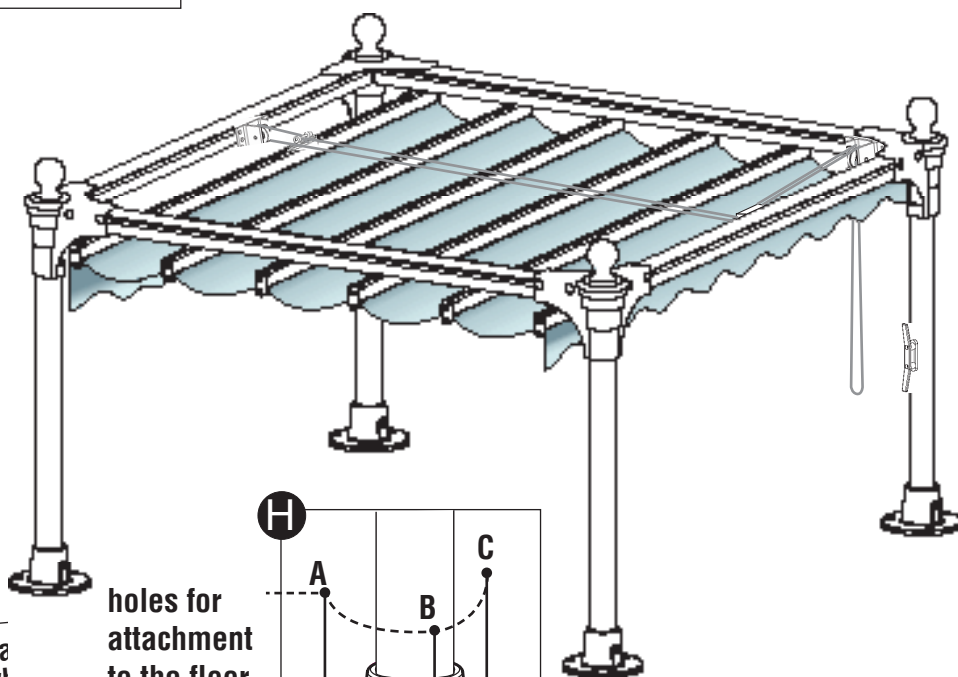

**holes for  
attachment  
to the floor**

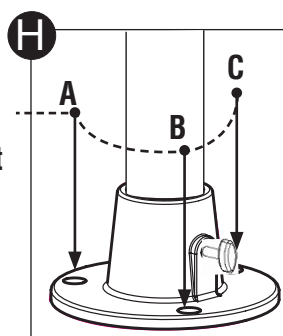

**For your safety don't deploy your pergola  
heavy wind, and don't forget to close it when  
you're not home.  
Check the attachment to the floor very often**